

MARK	QTY	SIZE	EQUIPMENT LISTING	MARK	QTY	SIZE	EQUIPMENT LISTING	MARK	QTY	SIZE	EQUIPMENT LISTING
A	1	10'	HYDROSTATIC DOUBLE WALL COMPARTMENT TANK	I	1*		INVENTORY & LEAK DETECTION PANEL	Q	2*		OVERFILL PREVENTION VALVE
B	2	48	DOUBLE WALL CONTAINMENT COLLAR	J	4*		CONTAINMENT COLLAR SENSOR	R	2*	4"	DROP TUBE
C	2	48	HYDROSTATIC DW PTS WATER TIGHT TANK SUMP	K	4*		HYDROSTATIC SUMP RESERVOIR SENSOR	S	4*	4"	BALL FLOAT ASSEMBLY
D	2	42	DOUBLE WALL CONTAINMENT COLLAR	L	2*		TANK INVENTORY GAUGE	T	2*	36"	RAIN TIGHT MANHOLE
E	2	42	HYDROSTATIC DW PTS OPEN TOP FILL SUMP	M	1*		HYDROSTATIC TANK RESERVOIR SENSOR	U	*	3"x2"	DOUBLE WALL FRP PIPE
F	6		HOLD DOWN SPLIT STRAP ASSEMBLY	N	2*	36"	MULTI-PORT SPILL CONTAINMENT MANHOLE	V	2*	4"	EXTRACTOR HOUSING w/ CAP
G	4	18'	18"x 8" CONCRETE DEADMAN ANCHORS	O	2*	2"	DW TANK VENT - MANIFOLDED w/UPWARD "V" CAP	W	1*	18"	MANHOLE
H	2*		SUBMERSIBLE PUMP w/LEAK DETECTION	P	1*	2"	DW SUMP VENT - MANIFOLDED w/UPWARD "V" CAP	X	1*		PUMP CONTROL PANEL

NOTE: \* SUPPLIED BY OTHERS

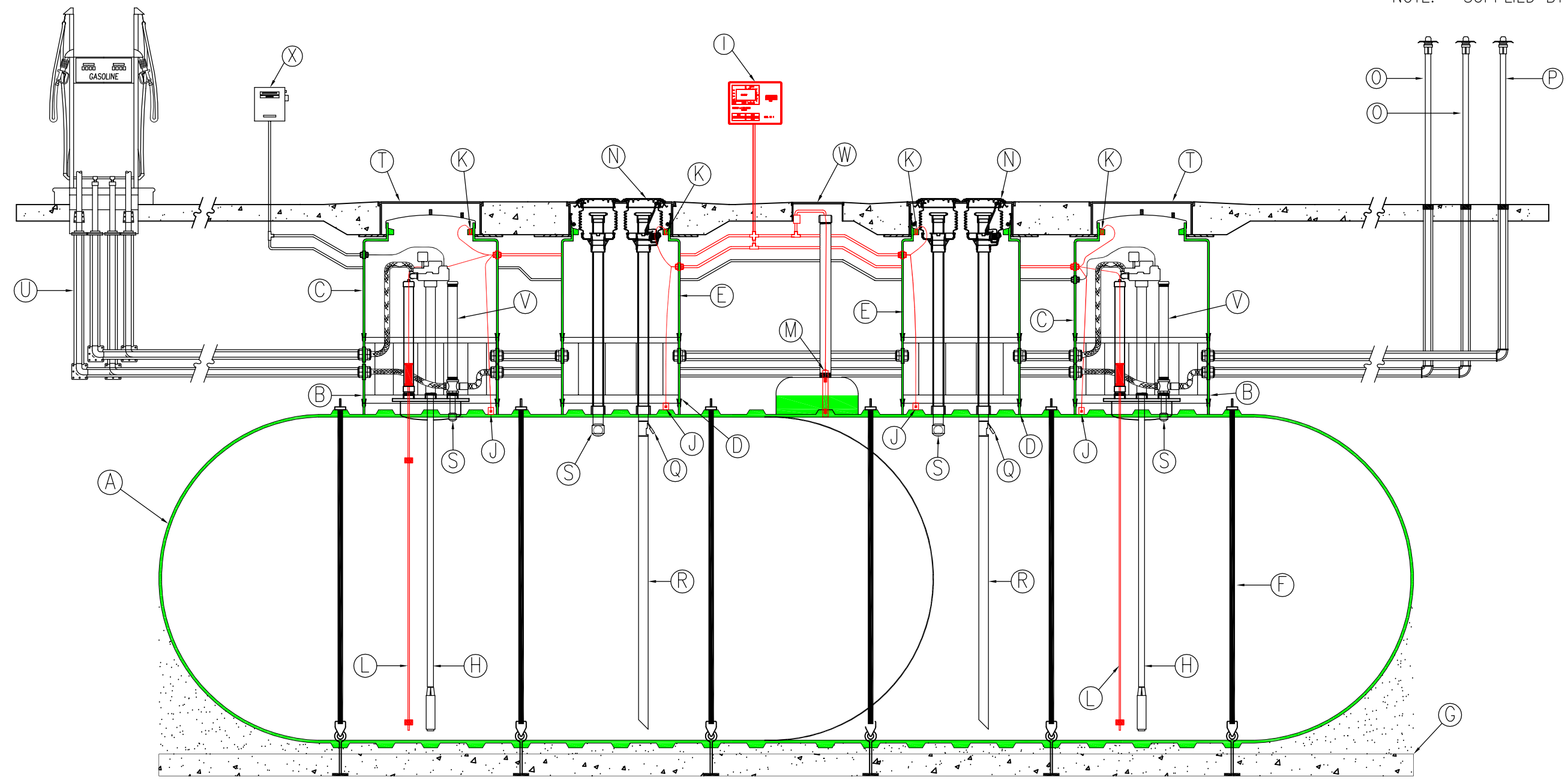

## HYDROGUARD™ SYSTEM COMPARTMENT TANK

### TYPICAL ILLUSTRATION DRAWING - DWT-6 SWB-2 (10')-12M/8M



THIS DIAGRAM IS THE PROPERTY OF CONTAINMENT SOLUTIONS, INC., AND IS FOR ILLUSTRATION PURPOSES ONLY. IT IS NOT TO BE RELIED UPON FOR ANY OTHER PURPOSE. NO WARRANTY OF MERCHANTABILITY OF FITNESS FOR A PARTICULAR PURPOSE OR OF ANY OTHER KIND, EXPRESSED OR IMPLIED IS HEREBY MADE. COPYRIGHT © 2005 CONTAINMENT SOLUTIONS, INC. ALL RIGHTS RESERVED.